

**IMPORTANT NOTE:**

OUTDURE STRUCTURES ARE ENGINEERED TO BE AN ACCEPTABLE SOLUTION TO ACHIEVE NZBC COMPLIANT BARRIERS. DETAILS PROVIDED ARE FOR STRUCTURAL SUPPORT SOLUTIONS. REFER TO HANDRAIL MANUFACTURERS SPECIFICATION FOR SPECIFIC FASTENING DETAILS. CONTACT OUTDURE FOR CONFIRMATION OF ANY DETAILS IF UNSURE.

**IMPORTANT NOTE:**

TRIM BOARD MUST HAVE OVERSIZED HOLES DRILLED FOR BALUSTRADE MOUNTING COLLARS TO FIT WITHIN.

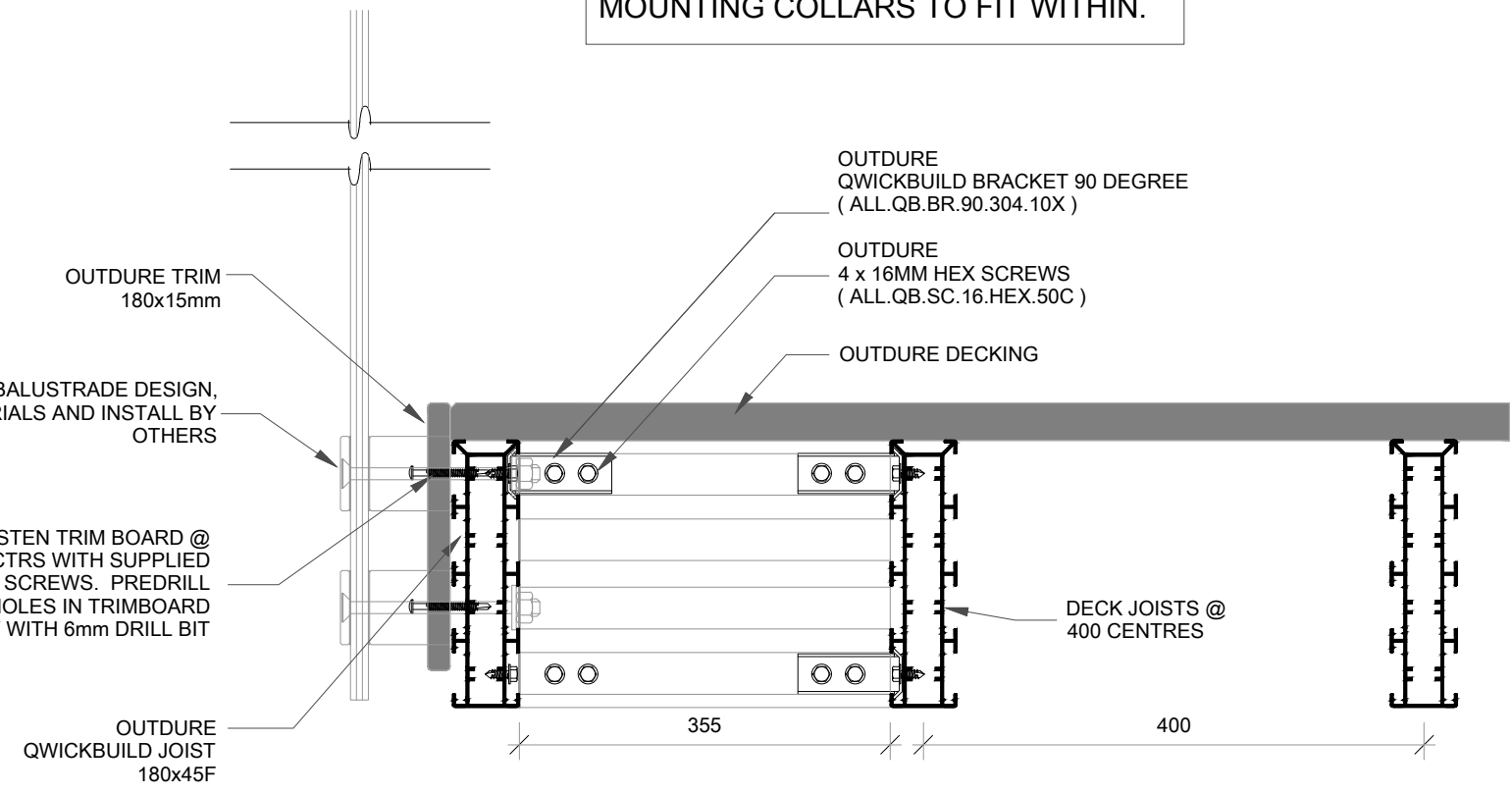
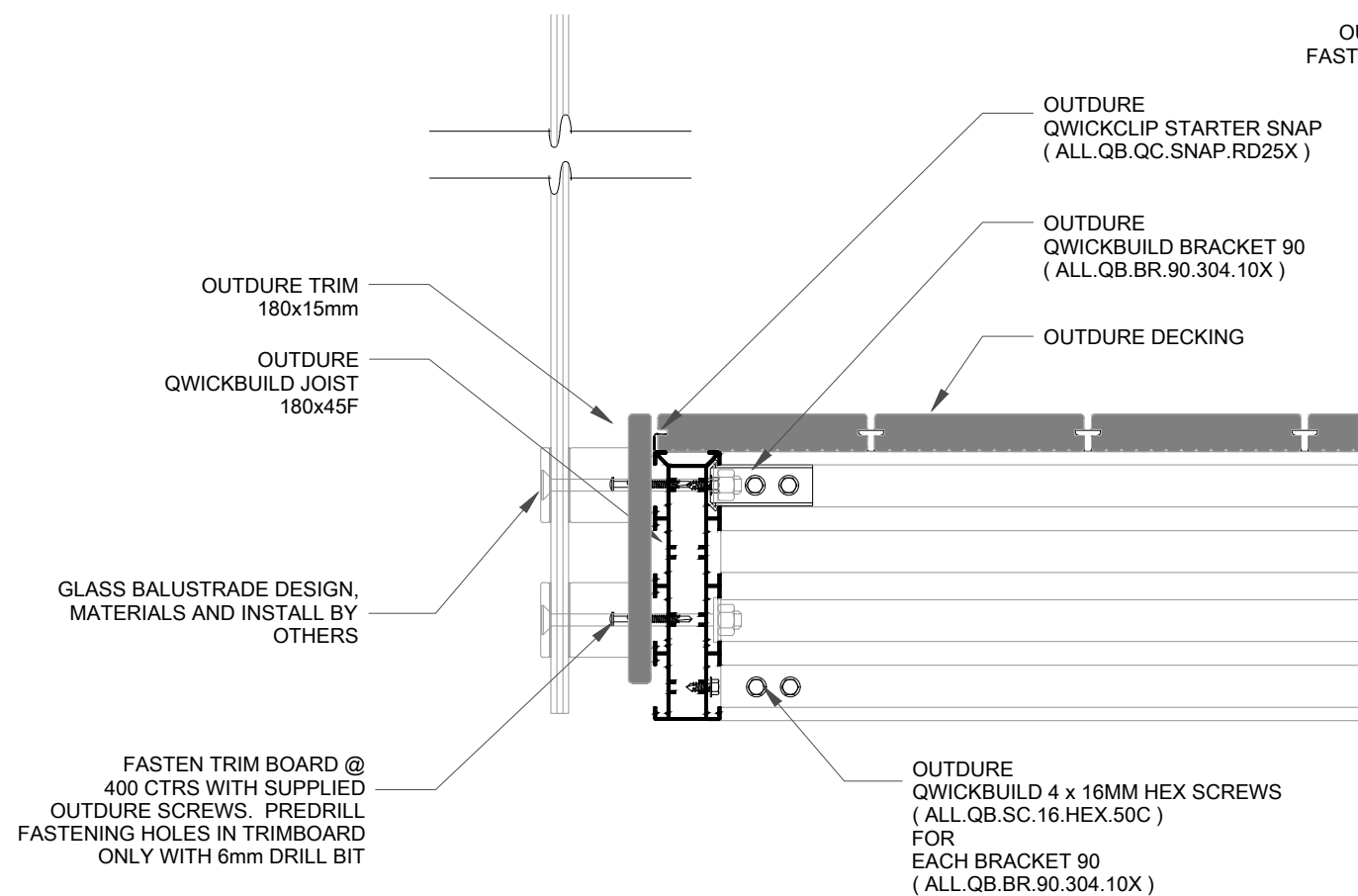

**2 QB-G6. BALUSTRADE PARALLEL TO JOIST DIRECTION FOR 180 JOIST**  
Scale : 1 : 5

**1 QB-G5. BALUSTRADE PERPENDICULAR TO JOIST DIRECTION FOR 180 JOIST**  
Scale : 1 : 5